

Installation Instructions for
307021440 or 307603594 FEMCO Weather Brake
Fits: International I-454, I-464, I-574 & I-674

Listed and shown below are the parts required to install the 1440 or 3594 Weather Brake. Carefully study the photographs and identify all parts before starting assembly. Verify that all parts are in the box. Follow the installation steps numerically.

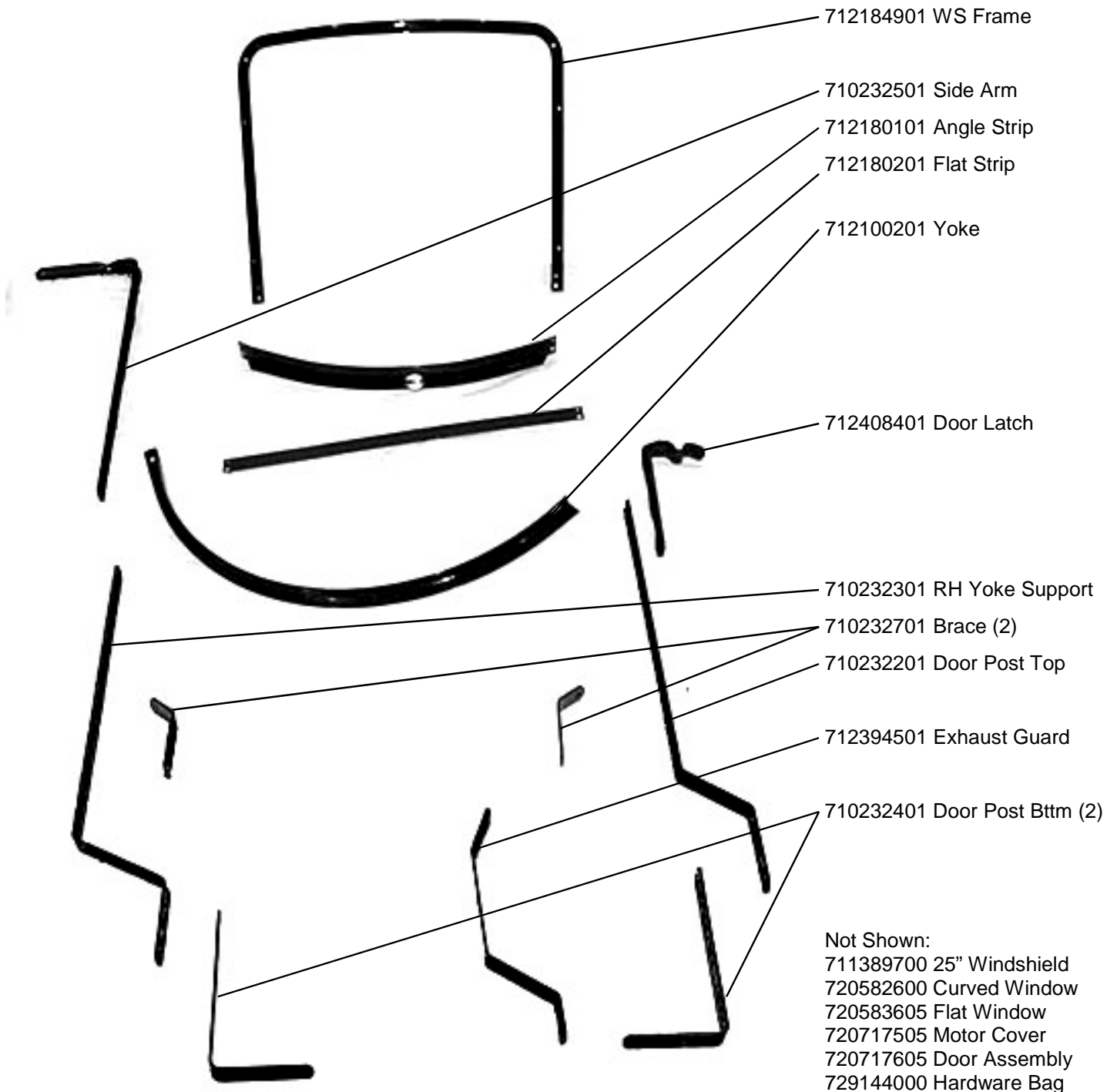

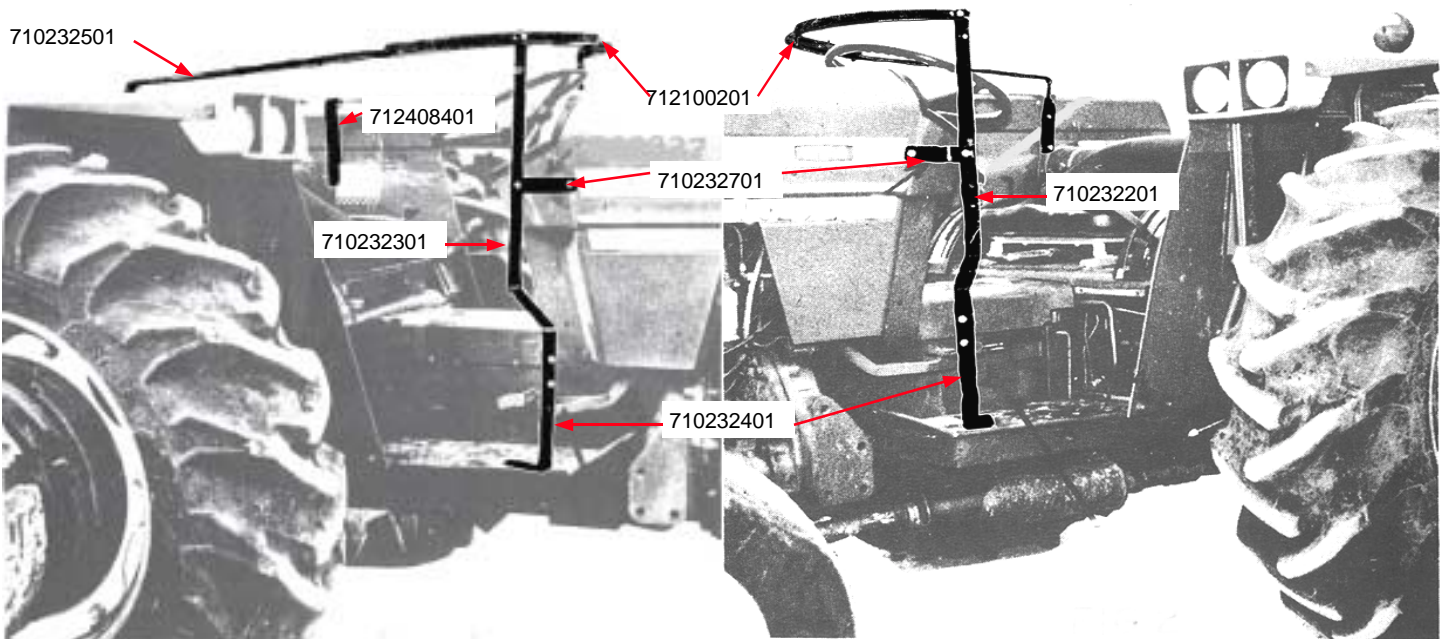

Figure 1

Figure 2

1. Attach # 710232701 Braces to tractor using 5/16x1" hex bolts. Long end bolts to tractor. See Figure 1 & 2

NOTE: The Door Post Bottom has 2 sets of holes for adjusting assembly length in step 2 & 3. Assemble the posts so the braces align with the proper holes in the posts when positioned approximately 90 degrees to the posts. Model 454 uses short set, Model 574 uses long set.

2. Attach # 710232201 Door Post Top to # 710232401 Door Post Bottom using 5/16x3/4" hex bolts and nuts. See Figure 2

3. Attach # 710232301 Right Yoke Support to # 710232401 Door Post Bottom using 5/15x3/4" hex bolts and nuts. See Figure 1

4. Place Motor Cover over tractor. Slide # 712100201 Yoke into wide hem at top. Slide Door Post up into wide hem on left side of Motor Cover. Attach top of Door Post Assembly to left side of Yoke and attach top of Right Yoke Support assembly to right side of yoke using 1/4x1" hex bolt and nut. Place bolt heads to rear and nuts to front.

5. Attach Braces to Door Post and Right Yoke Support assemblies using 5/16x3/4" hex bolts and nuts. Place braces on front side of posts.

6. Be sure posts are straight up and down front to back. Drill 11/32" diameter holes in foot rest using holes in Door Post Bottoms as templates. Attach to foot rests using 5/16x1" hex bolts and nuts



Step 2

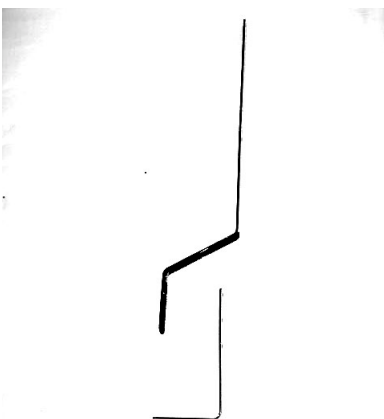

Step 3

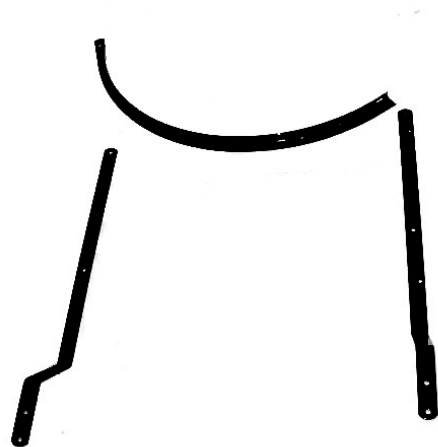

Step 4

7. Slide # 710232501 Side Arm into wide hem on right side of Motor Cover. Attach Side Arm to right hand end of Yoke using 3/8x1 1/2" hex bolt and wing nut. Place bolt head under assembly and nut on top. Attach back end of Side Arm to fender using 5.16x1" hex bolt and nut.

8. Straighten the Motor Cover on the tractor. Tie straps to grommets on side of the Motor cover. Attach springs to grommets on the other side of the Motor Cover. Attach straps to springs using buckles. Adjust straps so tension is maintained on springs.

9. Find hinge holes in Door Post and punch holes through Motor Cover at hole locations. Place Door Assembly level with the bottom of the Yoke and mark Door post hole locations. Cut slits in Door Assembly around wire frame and insert F1 clips. Attach F1 clips to Door Post using 3/16x3/4" hex bolts and nuts. Tie straps sewn on Motor cover to Door Assembly grommets. See Window Assembly Instructions

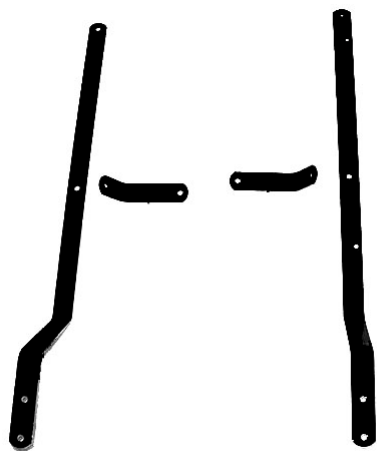

Step 5

10. Place # 712408401 Latch up under 2nd cut out in door and mark holes in fender. Drill two (2) 11/32" diameter holes and attach Latch to fender using 5/16x1" hex bolts and nuts

11. If tractor is equipped with down exhaust attach # 712394501 Exhaust Guard over exhaust to prevent Motor Cover from contacting pipe. See Figure 3

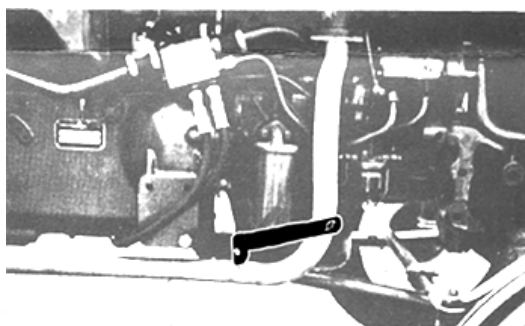
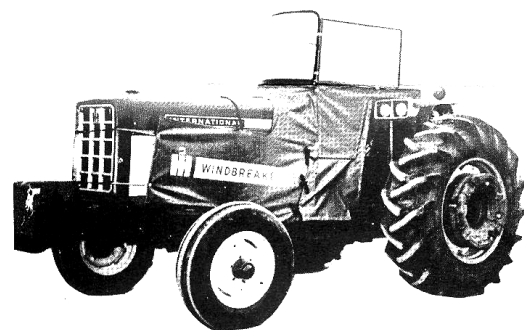

Figure 3



Step 7



WINDSHIELD/SIDE WINDOW ASSEMBLY INSTRUCTIONS

The pictures shown are generic drawings. The part shapes shown may vary from the parts supplied with this WB. The descriptions should be correct. Follow the instructions by step.

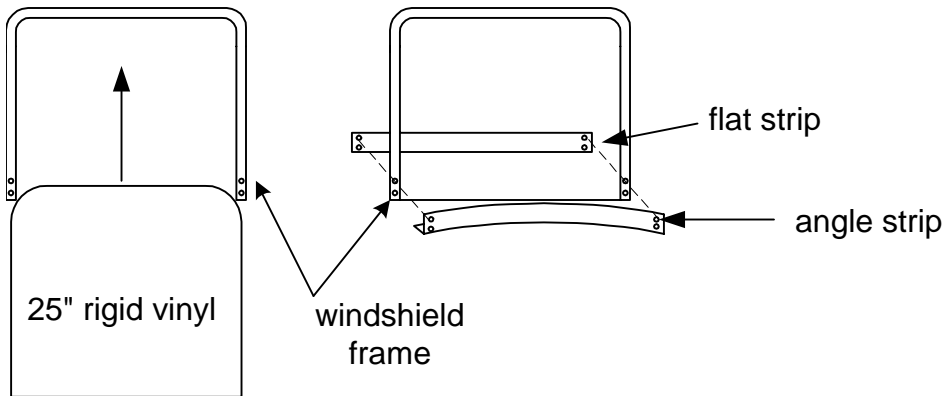

1. Slide the rigid vinyl into the windshield frame
2. Fasten the flat strip and angle strip to the windshield frame using 2 - 3/16 x 3/4 bolts in the top holes. Tighten nuts.

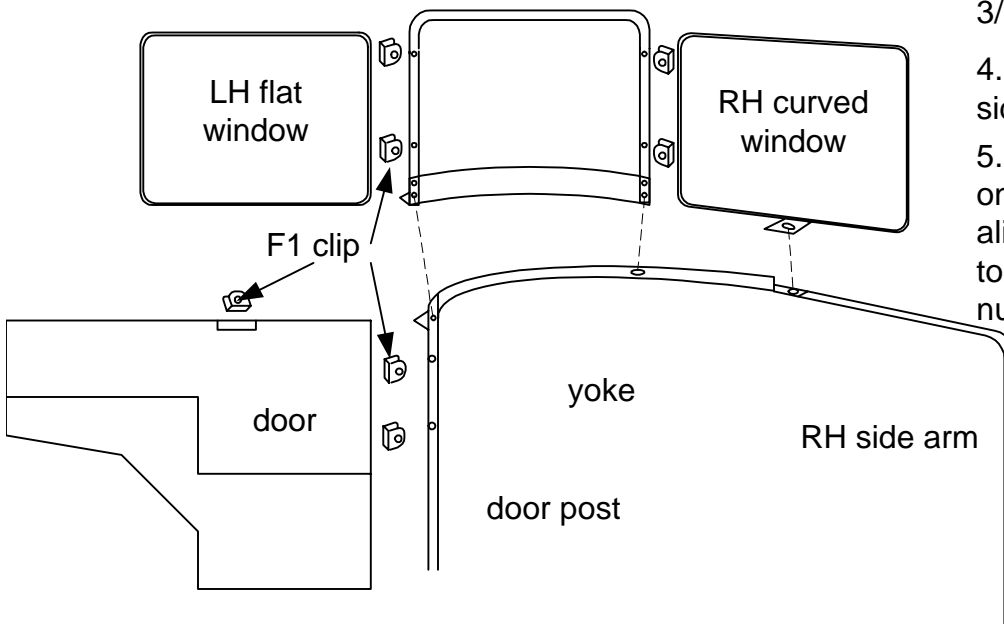

3. Cut slots in RH curved window to match holes in frame. Insert F1 clips in slots, around wire, and bolt to frame using 2- 3/16 x 3/4" bolts and nuts
4. Repeat step 3 for LH side window.
5. Place windshield assembly on yoke so lower RH hole aligns with slot in yoke. Bolt to yoke using 1/4 x 1 bolt and nut.

6. Remove nut, place lower LH hole over existing bolt at door post/yoke and replace nut.

7. Remove the nut and place the bottom of the RH side window over the existing bolt at the yoke/ side arm. Replace the nut.

8. Place an F1 clip through the cut out in the top of the door. Punch a small hole through the vinyl in the LH side window and bolt using a 3/16 x 3/4 bolt and nut



General Offices
1132 W. 1ST STREET
Mcpherson, KS 67460
Phone: 620-241-3513
Toll Free 1-800-677-0898
Fax: 620-241-3532
www.femcomfg.com